

YA.0424.000 XYA-021

CLG OFFROAD CLUTCH YAMAHA YZ 85 (2024)

MOUNTING INSTRUCTION

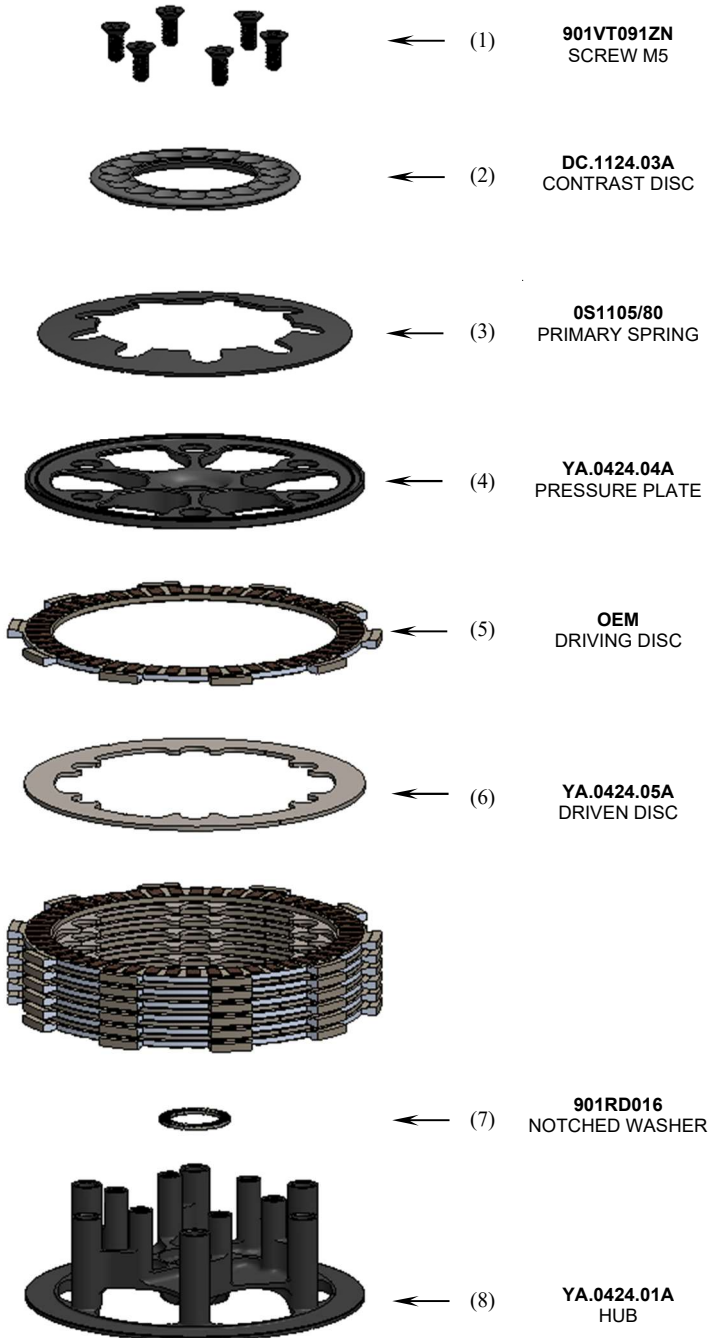

The operation of the clutch is closely related to the height of the disc pack. It is therefore necessary to measure the discs set before mounting. From the original clutch take only the driving discs, then assemble the disc pack using the driven discs (6) supplied in the package and take the measurement.

The total height of the disc pack must be equal to 30 ± 0.2 mm. Then insert the hub (8) on the primary shaft, bringing it above the original spacer present above the bell. Place the notched washer (7) on the hub (8) and screw the original nut to the tightening torque prescribed by the engine manufacturer.

Install the disc pack on the hub (8), starting with a driving disc (6), and alternate with the subsequent discs until you reach the last driving disc (6). Do not install the judder spring ring (conical ring) or the shim if they are present in the standard clutch.

After that, install the original clutch lift control.

Then position the pressure plate (4) on the newly mounted disc pack, paying particular attention to correctly align the pressure plate with respect to the hub and keeping the code written on the pressure plate (4) visible to the operator. The larger diameter holes on the pressure plate (4) must coincide with the columns on the hub (8) as shown in the following image.

ATTENTION if this assembly is not carried out correctly, breakages or malfunctions could occur.

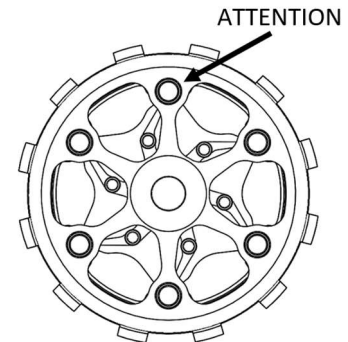

Position the primary spring (3) in the seat on the pressure plate (4). Then install the contrast disc (2) keeping the code writing visible to the operator.

The contrast disc (2) is also a spring preload adjustment member (3). Make sure to position it by resting it on the hub turrets (8) in correspondence with the highest holes (Position 1), so as to have the correct spring preload (3).

It can be rotated and then placed on the turrets in correspondence with the lowest holes when the disc pack is lower than the nominal by at least 0.2 mm (Position 2) or at least 0.4 mm (Position 3).

Tighten the screws (1) evenly, tightening with a torque wrench to a maximum torque of 8 Nm.

ATTENTION if this assembly is not carried out correctly, breakages or malfunctions could occur.

Once the assembly is complete, repeatedly activate the clutch lever, ensuring that it functions correctly.

Enjoy!

GENERAL SAFETY REGULATIONS

- IN THIS SHEET ARE REPORTED THE DIRECTIONS TO PERFORM CORRECTLY THE CLUTCH ASSEMBLY OPERATIONS
- STM RESERVES THE RIGHT, WITHOUT NOTICE, TO INTRODUCE ANY TECHNICAL CHANGE WHENEVER DEEMED IT TO BE NECESSARY TO IMPROVE FUNCTION AND QUALITY OF THE PRODUCTS
- **STM ITALY SRL PRODUCTS ARE EXCLUSIVELY INTENDED FOR COMPETITION, NOT SUITABLE ON MOTORBIKES ON PUBLIC ROADS.**
- ASSEMBLY OPERATIONS MUST BE PERFORMED BY A SKILLED TECHNICIAN AND MUST BE SCRUPULOUSLY OBSERVED
- BEFORE MOUNTING THE CLUTCH MAKE A COMPLETE INSPECTION OF THE MOTORBIKE COMPONENTS, IN ORDER TO VERIFY THE POSSIBLE PRESENCE OF FAULTS OR ANOMALIES ON THE VEHICLE
- MAKE SURE THAT THERE ARE NO MISSING/DAMAGED PARTS IN THE CLUTCH KIT
- SOME PARTS OF THE CLUTCH AND ITS COMPONENTS CAN HAVE SHARP SURFACE: HANDLE WITH CARE
- SOME COMPONENTS OF THE CLUTCH, BECAUSE OF THEIR SMALL DIMENSIONS CAN BE SWALLOWED: KEEP AWAY FROM CHILDREN

RULES FOR PRODUCT CARE AND CLEANING

- ANODIZED and/or LEXAN PARTS:** DO NOT USE on both glossy and matt anodized parts or on lexan components any type of acid or alkaline based degreaser. Use only neutral-based soaps. We recommend using a soft, non-abrasive, damp and clean microfibre cloth or synthetic sponge to avoid abrasions and scratches on surfaces. However, the use of detergents containing alcohol or aggressive chemical products, but also pickling agents or acids is prohibited.
- Always wash your motorcycle cold, never hot.
- Do not use pressure washers, steam cleaning machines or any type of high pressure washing system or with high operating temperatures, any type of washing of these types can damage or permanently ruin the anodized surfaces or lexan.

STM ITALY
Via A. Olivetti 15 - 10020 - Riva presso Chieri (TO)
www.stmitaly.com - contact@stmitaly.com

